

*Perfecting the moment*

zhiyun-tech.com



# SMOOTH 2



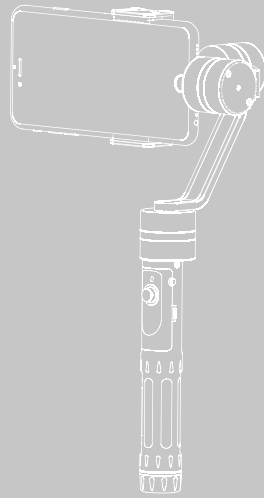

User Guide V1.4



# Contents

■ Packing List	1
■ Disclaimer and Warning	2
■ Battery Safety Guidelines	4
■ Quick Start Guide	8
■ Preparing and Charging the Batteries	9
■ APP Download and Installation	10
■ Smartphone Installation	11
■ Gravity Center Adjustment	12
■ Start Up	13
■ Introducing Gimbal Control Modes	16
■ Introducing Connection Ports and Various Operations	17
■ APP Operations	18
■ Usage of Main Accessories	20
■ Initializing the Stabilizer	24
■ On-line Calibration	25
■ Product Specifications	26
■ Warranty Card	27

The product package comes with the following items. In case that any item is found missing, please contact ZHIYUN or your local selling agent.

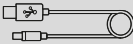
 SMOOTH 2 3-Axis Smartphone Stabilizer1	 18650B Li-ion Battery1
 Camera Protection Sticker for Pan Axis Motor1	 Counterweight1
 Micro USB Cable1	

Thank you for using ZHIYUN SMOOTH 2. The information contains herein affects your safety and your legal rights and responsibilities. Read this entire document carefully to ensure proper configuration before use. Failure to read and follow the instructions and warnings herein may result in serious injury to you or bystanders, or damage to your device or property.

ZHIYUN reserves the right of final explanation for this document and all relevant documents relating to SMOOTH 2, and the right to make changes at any time without notice. Please visit [www.ZHIYUN-TECH.com](http://www.ZHIYUN-TECH.com) for the latest product information. By using this product, you hereby signify that you have read this document carefully and that you understand and agree to abide by the terms and conditions herein. You agree that you are solely responsible for your own conduct while using this product, and for any consequences thereof. You agree to use this product only for purposes that are proper and in accordance with all terms, precautions, practices, policies and guidelines ZHIYUN has made and may make available.

ZHIYUN™ accepts no liability for damage, injury or any legal responsibility incurred directly or indirectly from the use of this product. Users shall observe safe and lawful practices including, but not limited to, those set forth herein.

ZHIYUN™ is the trademark of Guilin Zhishen Information Technology Co., Ltd. (hereinafter referred to as "ZHIYUN" or "ZHIYUN TECH") and its affiliates. All product names or marks referred to hereunder are trademarks or registered trademarks of their respective holders.

Glossary

The following terms are used throughout the product literature to indicate various levels of potential harm when operating this product.

WARNING: Procedures, which if not properly followed, may incur property damage, grave accident, or serious injury.

CAUTION: Procedures, which if not properly followed, may incur property damage and serious injury.

NOTICE: Procedures, which if not properly followed, may incur property damage or minor injury.

WARNING

Read the ENTIRE User Guide to become familiar with the features of this product before operating. Failure to operate the product correctly can result in damage to the product or personal property and cause serious injury. This is a sophisticated product. It must be operated with caution and common sense and requires some basic mechanical ability. Failure to operate this product in a safe and responsible manner could result in injury or damage to the product or other property. This product is not intended for use by children without direct adult supervision. DO NOT use with incompatible components or in any way otherwise as mentioned or instructed in the product documents provided by ZHIYUN. The safety guidelines herein contain instructions for safety, operation and maintenance. It is essential to read and follow all of the instructions and warnings in the User Guide, prior to assembly, setup or use, in order to operate the product correctly and avoid damage or serious injury.

Safe Operation Guidelines

- CAUTION:  
1.SMOOTH 2 is a high-precision control device. Damage may be caused to SMOOTH 2 if it is dropped or subject to external force, and this may result in malfunction.  
2.Make sure the rotation of the gimbal axes is not blocked by external force when SMOOTH 2 is turned on.  
3.SMOOTH 2 is not waterproof. Prevent contacts of any kind of liquid or cleaner with SMOOTH 2. It is recommended to use dry cloth for cleaning.  
4Protect SMOOTH 2 from dust and sand during use.
- NOTICE:  
Keep the handle stable when SMOOTH 2 is powered on, as shaking may cause failure to start up.

This document is subject to change.  
ZHIYUN™ is a trademark of ZHIYUN.  
Copyright©2017 ZHIYUN. All rights reserved.

Disclaimer

This Battery Safety Guidelines and all relevant documents are subject to change at the sole discretion of ZHIYUN. ZHIYUN reserves the right to make changes at any time without notice. For updated product information, please visit ZHIYUN's official website.

Glossary

- WARNING: Procedures, which if not properly followed, may incur property damage, grave accident, or serious injury.
- CAUTION: Procedures, which if not properly followed, may incur property damage and serious injury.

WARNINGS

Read the ENTIRE User Guide to become familiar with the features of this product before operating. Failure to operate the product correctly can result in damage to the product or personal property and cause serious injury. This is a sophisticated product. It must be operated with caution and common sense and requires some basic mechanical ability. Failure to operate this product in a safe and responsible manner could result in injury or damage to the product or other property. This product is not intended for use by children without direct adult supervision. DO NOT use with incompatible components or in any way otherwise as mentioned or instructed in the product documents provided by ZHIYUN. The safety guidelines herein contain instructions for safety, operation and maintenance. It is essential to read and follow all of the instructions and warnings in the User Guide, prior to assembly, setup or use, in order to operate the product correctly and avoid damage or serious injury.

- WARNING  
To avoid fire, serious injury, and property damage, observe the following safety guidelines when using, charging, or storing your batteries.

Battery Use

- 1.Prevent the batteries to come into contact with any kind of liquid. Do not leave batteries out in the rain or near a source of moisture. Do not drop the battery into water. If the inside of the battery comes into contact with water, chemical decomposition may occur, potentially resulting in the battery catching on fire, and may even lead to an explosion.
- 2.If the battery falls into water with the stabilizer during use, take it out immediately and put it in a safe and open area. Maintain a safe distance from the battery until it is completely dry. Never use the battery again, and dispose of the battery properly as described in the Battery Disposal section below.
- 3.If the battery catches fire, use water, water spray, sand, fire blanket, dry powder, or carbon dioxide fire extinguisher immediately to put out the fire. Please extinct the fire by applying the methods recommended above according to the actual situation.
- 4.Never use non-ZHIYUN batteries. If replacement or backup is needed, please purchase new batteries from ZHIYUN's official website or authorized channels. ZHIYUN takes no responsibility for any damage caused by non-ZHIYUN batteries.
- 5.Never use or charge swollen, leaky, or damaged batteries. Never use or charge if the battery smells, or overheats (exceeding maximum temperature of 160°F / 71°C). If your batteries are abnormal, contact ZHIYUN or a ZHIYUN authorized dealer for further assistance.
- 6.The battery should be used within the temperature range from -10°C to 50°C. Use the battery in environments above 50°C can lead to a fire or explosion. Use of battery below -10°C can lead to serious battery damage.
- 7.Do not use the battery in strong electrostatic or electromagnetic environments. Otherwise, the battery protection board may malfunction.
- 8.Do not disassemble or use any sharp object to puncture the battery in any way. Otherwise, the battery may leak, catch fire or explode.
- 9.Do not mechanically strike, crush, or throw the battery. Do not place heavy objects on the battery or charger.
- 10.Electrolytes inside the battery are highly corrosive. In case of accidental contact of any electrolytes with your skin or eyes, rinse immediately with water for at least 15 minutes and seek medical advice as soon as possible.
- 11.Do not use the battery if it has been involved in a crash or heavy impact.
- 12.Do not heat the battery and never put the battery in a microwave oven or in a pressurized container.

- 13.Do not place the battery cell on a conductive surface (such as a metal desk surface).
- 14.Prevent use of wires or other metal objects that could cause positive and negative short-circuit to the battery.
- 15.If the battery terminal is dirty, wipe it with a clean, dry cloth. Otherwise it will cause a bad battery connection, which may result in energy loss or charging failure.

Battery Charging

- 1.Do not attach the batteries to a wall outlet or car charger socket directly. Always use a ZHIYUN approved adapter for charging. ZHIYUN takes no responsibility if the battery is charged using a non-ZHIYUN charger.
- 2.Do not put the battery and charger near flammable materials or on flammable surfaces (such as carpet or wood). Never leave the battery unattended during charging to prevent any accident.
- 3.Do not charge the battery immediately after use, because the battery temperature may be too high. Do not charge the battery until it cools down to normal room temperature. Charging the battery with its temperature over 40°C or lower than 15°C may lead to leakage, overheating, or damage.
- 4.Examine the charger before use, make sure there is no damage to the enclosure, cord, plug, or other parts. Never use a damaged charger. Do not clean the charger with any liquid containing alcohol or other flammable solvents. Disconnect the charger when not in use.

Battery Storage

- 1.Keep batteries out of the reach of children and pets.
- 2.Do not leave the battery near heat sources such as a furnace or heater, or inside of a vehicle on hot days. Never expose the battery in any environment with temperature of over 60°C. The ideal storage temperature is 22°C-28°C.
- 3.Store batteries in a dry environment.
- 4.Do not leave the battery unused for too long after it has been completely discharged to prevent over-discharge of battery which may result in battery damage and permanent failure.

Battery Maintenance

- 1.Never use the battery when the temperature is too high or too low.
- 2.Do not store the battery in any environment with a temperature of over 60°C.

**Battery Maintenance**

- 1.Never use the battery when the temperature is too high or too low.
- 2.Do not store the battery in any environment with a temperature of over 60°C.

**Transportation Notice**

- 1.Discharge the battery power to 5% or lower before carrying the battery on an airline flight. Only discharge the battery in a fireproof location, ideally in a dry and open area.
- 2.Do not store or transport batteries together with metal objects such as eyeglasses, watch, and jewelries, etc.
- 3.Do not transport damaged batteries. When transporting, be sure to discharge the battery to less than 50%.

**Battery Disposal**

Dispose of the battery in specific recycling boxes only after a complete discharge. Do not put away the battery in regular trash containers. Strictly follow your local regulations regarding the disposal and recycling of batteries.

**Battery Use**

Make sure the batteries are fully charged before each time of use.

**Battery Charging**

The battery will stop charging automatically when it is full. Disconnect the batteries from the charger when fully charged.

**Battery Storage**

- 1.Discharge the battery to 40%-65% if it will NOT be used for over 10 days. This can greatly extend the battery life.
- 2.The battery enters hibernation mode when voltage gets too low. Charge the battery will bring it out of hibernation.
- 3.Remove batteries from the stabilizer when not in use and store them in a specialized container.

**Battery Maintenance**

Never over-discharge, as this may lead to battery cell damage. Battery performance may be affected if not used for a long time. Charge and discharge the battery once every 3 months to keep it active.

**Battery Disposal**

If the battery cannot be fully discharged, do not leave it in the recycling box, but contact a professional battery disposal/recycling agent for further assistance.

Get to Know SMOOTH 2

Check the product package before use, make sure that all items below have arrived with the product. In case that any item is found missing, please contact ZHIYUN or your local selling agent.

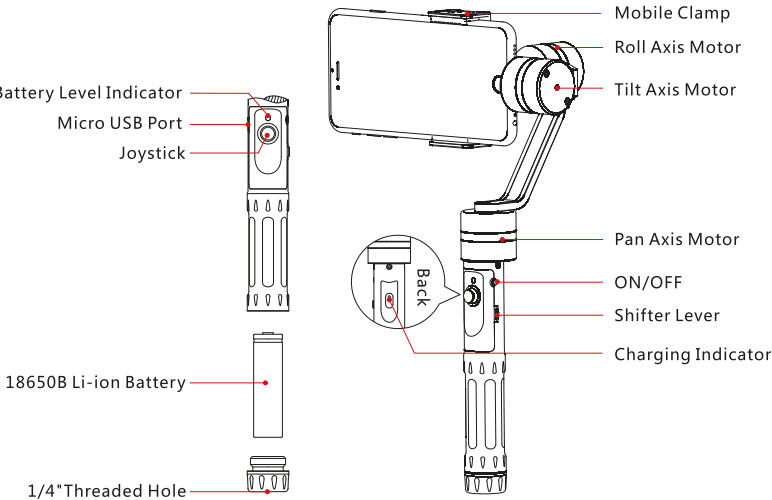

The Micro USB cable can be used for direct charging of SMOOTH 2 without need to take out the battery. In addition, it can also be used for firmware upgrade and calibration by connecting the stabilizer to a computer.

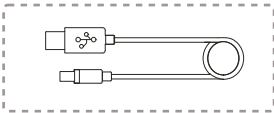

Micro USB Cable  
18650B Li-ion Battery  
Capacity: 3400mAh  
Voltage: 3.7V

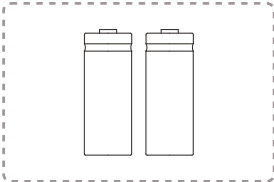

**NOTICE**  
This charging method is for charging ZHIYUN's 18650B Li-ion Battery only. Do not charge batteries of other models or brands, otherwise it may lead to accident.  
  
Charging time depends on the max. output current of the adapter.

**⚠ Please use and charge batteries provided or approved by ZHIYUN only. ZHIYUN will not take any responsibility for explosion, fire and/or accidents caused by non-ZHIYUN batteries.**

Reading Tips

Legends: Hints and tips Important

APP Download and Installation



Download the APP from ZHIYUN's official website [www.ZHIYUN-TECH.com](http://www.ZHIYUN-TECH.com), or by directly scanning the QR code on the left (Android 4.3 above or iOS8.0 above required) to download. iOS users can download the APP by searching "ZY Play" in APP Store.

**⚠ The ZHIYUN APP is subject to regular update, try out now to discover more functions.**



## Smartphone Installation

Push and hold open the camera clamp, slide the smartphone in as close as possible to the motor on the side, and clamp on.

⚠ Do not power on the stabilizer before the smartphone is properly mounted.

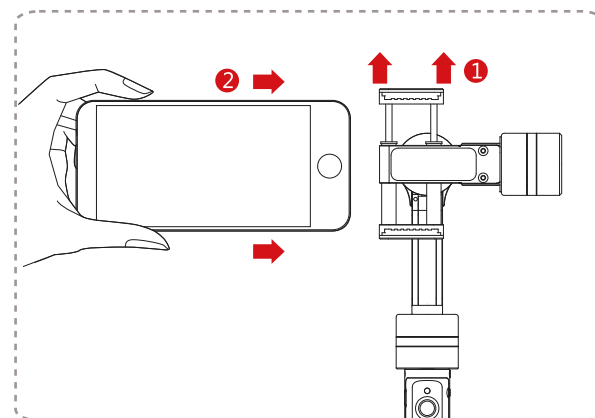

## Gravity Center Adjustment

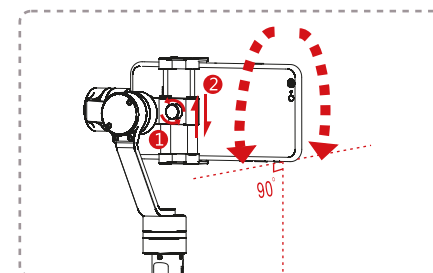

If the smartphone tilts forward/backward on tilt (X) axis, loosen Thumb Screw ① at the back of the mobile clamp. Adjust the active plate ② up/down until the smartphone stays still and vertical on X axis. Turn the smartphone at any angle to check if the smartphone will tilt, if the smartphone can stay still, then the adjustment is successful.

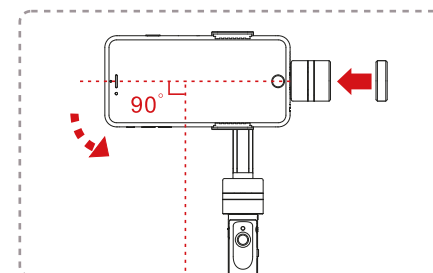

In the event when the smartphone is too heavy and keeps falling on the Roll (Y) Axis, then a counterweight shall be added on to the Tilt Axis Motor to compensate, and keep balance of the smartphone to ensure normal operation of the stabilizer. Counterweight is required for any smartphone with sizes same as or bigger than iPhone 6 Plus, otherwise the stabilizer cannot function normally.

⚠ Proper adjustment of gravity center ensures better power saving during operation. The stabilizer may still function well when the gravity center is not properly configured, however, it may lead to more power consumption on the motors, and greatly affect the torque output.

Control Panel Introduction

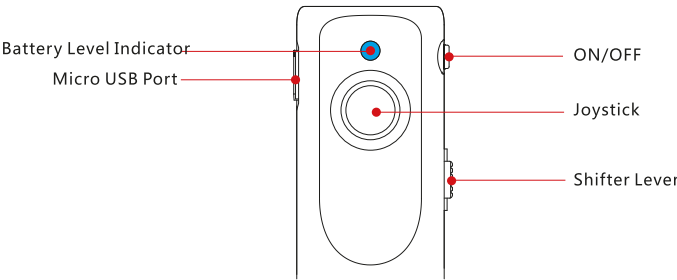

Shifter Lever Operation

When connected to the smartphone with APP on, use the Shifter Lever to make the following operations:

- a. Switch between the main and front cameras by pushing up the Shifter Lever.
- b. Switch between PHOTO and VIDEO shooting by pushing down the Shifter Lever.
- c. During video recording, push up the Shifter Lever to zoom in, and push down to zoom out.

ON/OFF

Power on the stabilizer by pressing the Power button for about 3 sec. After the stabilizer is powered on, the Power button can be used for camera shooting control (only when the Mobile APP is on).

Single press the button to take photos.

Double press the button to start video recording. Double press the button again to stop recording.

Control Panel Introduction

Battery Level Indicator

Shines YELLOW light when the stabilizer is powered on/off:

Quick flash for 3 sec. and shines solid for 1 sec. when powered on.

Quick flash for 3 sec. when powered off.

Shines BLUE light when the stabilizer is in normal operation, the flashing frequency of the BLUE light indicates the current battery level:

Quick flash 4 times for battery level of 76%-100%.

Quick flash 3 times for battery level of 51%-75%.

Quick flash 2 times for battery level of 26%-50%.

Quick flash 1 time for battery level of 1%-25%.

Micro USB Port

Connect the stabilizer with a computer using a Micro USB cable for firmware upgrade and on-line calibration.

Joystick Operation

Joystick controls the camera movement by turning the 3 axes up/down or left/right.

How to Power ON/OFF

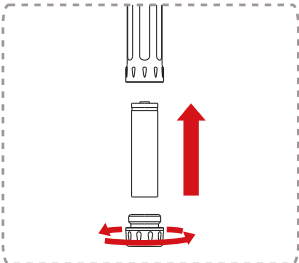

Rotate to loosen the end cover, then install the 18650B Li-ion battery. Make sure to tighten the end cover properly after battery installation, or the stabilizer cannot be turned on.

Batteries shall be installed with the positive pole heading the arrow direction as shown in the figure.

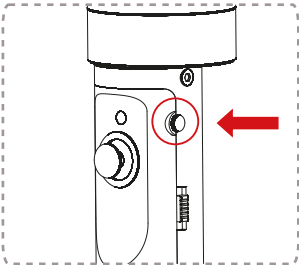

After the batteries are installed properly, long press the power button for 3 sec. to power on.

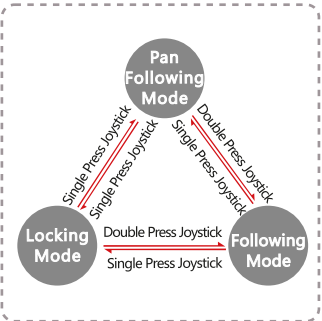

Mode Switch Schematic Figure

Mode switch:  
The stabilizer enters Pan Following Mode by default each time when powered on. Switch into Locking Mode by single pressing on the Joystick. Double press the Joystick to enter the Following mode. Single press the Joystick under the Following Mode will return to the previous mode.

See ZHIYUN's product training videos on [www.ZHIYUN-TECH.com](http://www.ZHIYUN-TECH.com) for more operation tips.

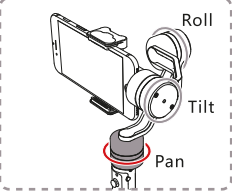

**Pan Following Mode:** The camera pans left/right following the movement of the stabilizer while the tilt and roll axes are locked. Push the joystick up/down allows manual control of the tilt axis.

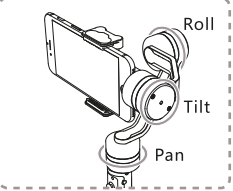

**Locking Mode:** This mode locks movement of all three axes to keep the camera still and stable. Push the joystick up/down and left/right allows manual control of the tilt axis and pan axis.

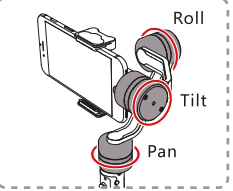

**Following Mode:** The camera pans and tilts following the movement of the stabilizer. Push the joystick left/right allows manual control of the roll axis.

## Micro USB Port

1. Connect the stabilizer to your computer using the Micro USB cable for firmware upgrade and on-line calibration.
2. Connect the stabilizer to a power source for direct charging. The stabilizer can operate while charging.

## Firmware Upgrade

1. Visit ZHIYUN's official website: [www.zhiyun-tech.com](http://www.zhiyun-tech.com).
2. Click to open the "Downloads" page, and find the Firmware Upgrade Tutorial package.
3. Download the driver, calibration tool and latest firmware corresponding to your stabilizer.
4. Upgrade firmware following the instructions indicated in the Firmware Upgrade Tutorial.

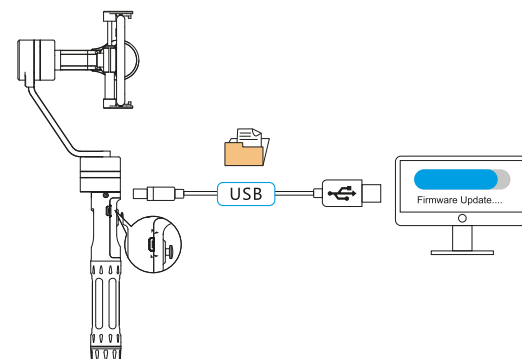

⚠ NOTICE: Make sure the battery is installed during upgrade.

## APP Download and Installation



Download the APP from ZHIYUN's official website [www.ZHIYUN-TECH.com](http://www.ZHIYUN-TECH.com), or by directly scanning the QR code on the left (Android 4.3 above or iOS8.0 above required) to download. iOS users can download the APP by searching "ZHIYUN" in APP Store.

⚠ The ZHIYUN APP is subject to regular update, try out now to discover more functions.

## Connecting the Stabilizer to Smartphone

1. Power on the stabilizer.
2. Tap ZHIYUN's APP icon to open.
3. Tap the signal icon on the top to activate Bluetooth and search for nearby signals, choose your stabilizer to connect.



Main Features of the APP



Monitoring screen: Allows checking of the stabilizer's working status.



Control screen: Allows various controls to the stabilizer, including change of Gimbal Control Mode and corresponding axis movement control.



Calibration screen: Calibration is required when deviations are found in the 3 axes and the leveling of the camera. Tap "Start Calibration", and complete the 6-side calibration procedure following onscreen illustrations.



Gimbal setting screen: Allows adjustment of various parameter settings of the stabilizer (Refer to APP instructions for specific operations.)

■ NOTICE: The Bluetooth Remote Control shall be purchased separately.

Bluetooth Remote Control

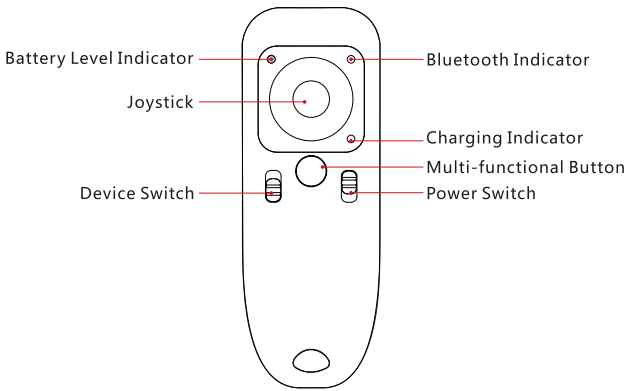

Specifications:

Charging voltage: 5V  
Charging current: 100mA  
Theoretical work time: ≥ 50 hr.  
Built-in Polymer lithium battery capacity: 150mAh  
Emission and received current: 11.9mA  
Operating current: 2.8mA  
Effective control distance: 10M (without blockage)

Pairing of Remote Control with the Stabilizer

When using the remote control for the first time, long press the Multi-functional Button while keeping the remote control near the stabilizer, and at the same time turn the Power Switch ON. The Bluetooth Indicator shines solid light when pairing is successful.

Bluetooth Remote Control

Battery Level Indicator

90%-100%: quick flash for 4 times each second.  
75%-90%: quick flash for 3 times each second.  
55%-75%: quick flash for 2 times each second.  
30%-55%: quick flash for 1 time each second.  
0%-30%: quick flashing.

Multi-functional Button

Single press this button to instruct the stabilizer to return to center position when connected to the stabilizer.

Device Switch

Turn up to connect the stabilizer.  
Turn down to connect the mobile.

Bluetooth Indicator

No connection: Continuous flashing.  
Connected: Shines solid light.  
Device switch: Flashes once.

Joystick

For camera movement control and mode switch (operates the same as the joystick of the stabilizer).

Charging Indicator

Charging: RED light.  
Charging complete: GREEN light.

Power Switch

Turn up to power on.  
Turn down to power off.

■ NOTICE: The Live Webcast Kit shall be purchased separately.

Live Webcast Kit

Packing List

Special Mobile Clamp & Mounting Plate	1	1.5mm Hex Socket Screwdriver	1
Counterweights (12g x2; 22g x 2)	4	M2.5 x 6 Screws	2

How to Install

1.Unscrew the screws to dismount the original mobile mounting plate from the stabilizer with the 1.5mm Hex Socket Screwdriver (as shown in the figure).

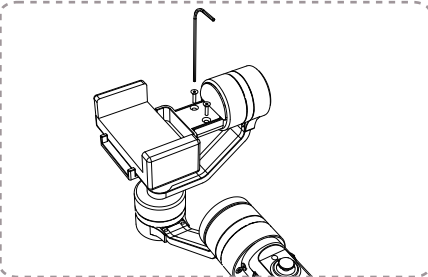

2. Install the Special Mobile Clamp & Mounting Plate to the stabilizer using the original screws or the screws that come with the Live Webcast Kit.  
3. Operate 6-side calibration after installation (Visit [www.zhiyun-tech.com](http://www.zhiyun-tech.com) for detailed tutorial on calibration method.).

**Usage**

1. When shooting in vertical mode, clamp on the smartphone on middle position (as shown in the figure) to keep balance.

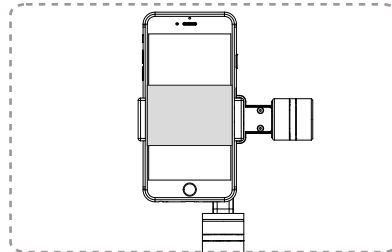

2. If large deviation occurs to the Roll Axis, add one or more pieces of counterweight as appropriate to the axis motor.  
3. By changing the mounting direction of the mobile clamp, the smartphone can be mounted either vertically or horizontally. Tighten up the Thumb Screw to complete installation.

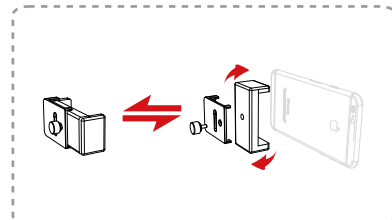

⚠ Make sure the mobile clamp is installed with the extendable part facing out/up.

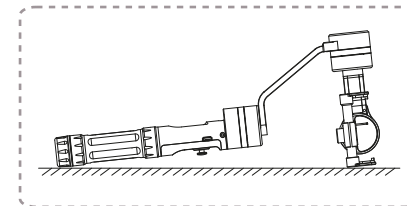
**Initializing the Stabilizer****Initialize the stabilizer under the following circumstances:**

1. Slight deviation is found in the tilt angle of the camera in level position after startup.
2. Slight deviation is found in the roll angle of the camera in level position after startup.
3. Frequent small angle correction is found when the camera is in level position while the stabilizer stays still.

**Initialization Procedure:**

1. Install the batteries and smartphone properly.
2. Power on the stabilizer.
3. Press the Joystick for 3 sec. to enter standby mode.
4. Put the stabilizer still on a table surface in random pose, wait for about 30 sec., and the stabilizer will automatically complete initialization.

On-line Calibration

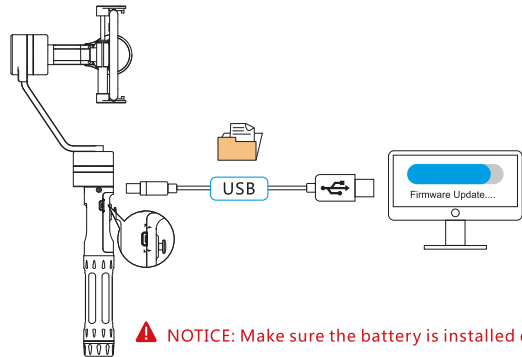

⚠ NOTICE: Make sure the battery is installed during upgrade.

Calibrate the stabilizer when any of the following circumstances occurs:

- 1. Deviation is found in the balancing of the smartphone even after initialization.
- 2. The stabilizer has not been used for a long time.
- 3. The stabilizer is exposed to significant temperature change.

Calibration Method

- 1. Visit ZHIYUN's official website: [www.zhiyun-tech.com](http://www.zhiyun-tech.com).
- 2. Click to open the "Downloads" page, and find ZHIYUN' s Gimbal Tools as well as online calibration tutorial; OR
- 3. Operate calibration on mobile APP by connecting to the smartphone.

	Min	Standard	Max	Remarks
Input Vol	3.6V		4.3V	
Operation Current			6000mA	
Operation Temperature	-10°C		45°C	
Operation Time	5h		7h	Well balanced with camera mounted
Weight		395g		Excluding batteries
Tilt Angle Range		320°		
Roll Angle Range		270°		
Pan Angle Range		360°		Unlimited rotation
Payload		200g		



Warranty Card

Warranty Period

1.Customers are entitled to replacement or free repair service in case of quality defect(s) found in the product within 15 days upon receipt of the product.  
2.Customers are entitled to free repair service from ZHIYUN for any product proven defective in material or workmanship that results in product failure during normal consumer usage and conditions within the valid warranty period, which is 12 months counting from the date of delivery.

This warranty does not apply to the followings

1.Products subjected to unauthorized repair, misuse, collision, neglect, mishandling, soaking, accident, and unauthorized alteration.  
2.Products subjected to improper use or whose labels or security tags have been torn off or altered.  
3.Products whose warranty has expired.  
4.Products damaged due to force majeure, such as fire, flood, lightning, etc.

Warranty Claim Procedure

1.If failure or any problem occurs to your product after purchase, please contact a local agent for assistant, or you can always contact ZHIYUN’ s customer service through email at service@zhiyun-tech.com or website at www.zhiyun-tech.com.  
2.Your local agent or ZHIYUN’ s customer service will guide you through the whole service procedure regarding any product issue or problem you have encountered.  
3.ZHIYUN reserves the right to reexamine damaged or returned products.

27

zhiyun-tech.com

Warranty Card

Custom information

Customer Name :Contact No :  
Address :  
Sales Manager  
Sales Date :Prod. Serial No :  
Dealer :  
Contact No :  
#1 Maintenance Record  
Service Date :Signature of Repairman :  
Cause of Problem :  
Service Result :☐Solved☐Unsolved☐Refunded/Replaced

zhiyun-tech.com

28

Contact Card



Website



Weibo



Vimeo



Google+



Facebook



Wechat



Youku



Youtube

Tel: +86-773-2320856  
Web: [www.zhiyun-tech.com](http://www.zhiyun-tech.com)  
E-mail: [service@zhiyun-tech.com](mailto:service@zhiyun-tech.com)  
Address: Creative Industrial Park, GuiMo Road, QiXing District, Guilin  
541004, Guangxi, China.



Please download the latest version from [www.zhiyun-tech.com](http://www.zhiyun-tech.com)  
This document is subject to change.  
ZHIYUN™ is a trademark of ZHIYUN.  
Copyright©2017 ZHIYUN. All rights reserved.